

**TORMAX**  
 AUTOMATIC  
 INSTRUCTION TN 110 1/2" THRESHOLD FABRICATION

\*\*\*\*\*  
**TORMAX**  
 AUTOMATIC

JOB NAME: \_\_\_\_\_ DATE: \_\_\_\_\_  
 DOOR LOCATION: \_\_\_\_\_ DOOR NO: \_\_\_\_\_ SHEET \_\_\_ OF \_\_\_

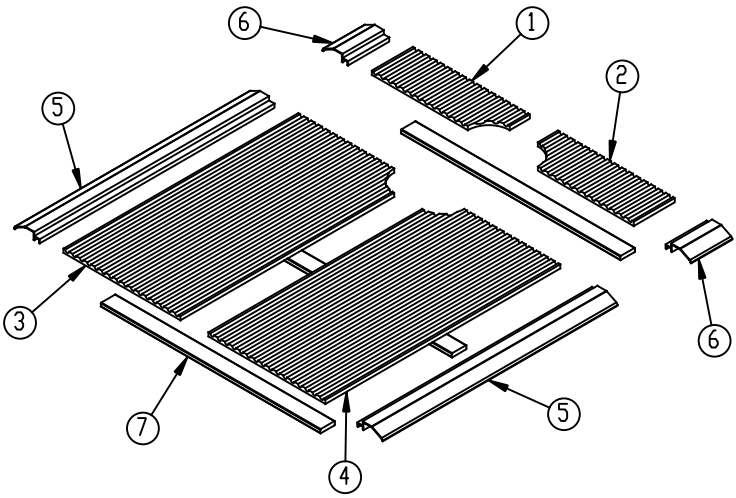

For easy access to operator without having to remove the door, a two-piece threshold is optional but not required

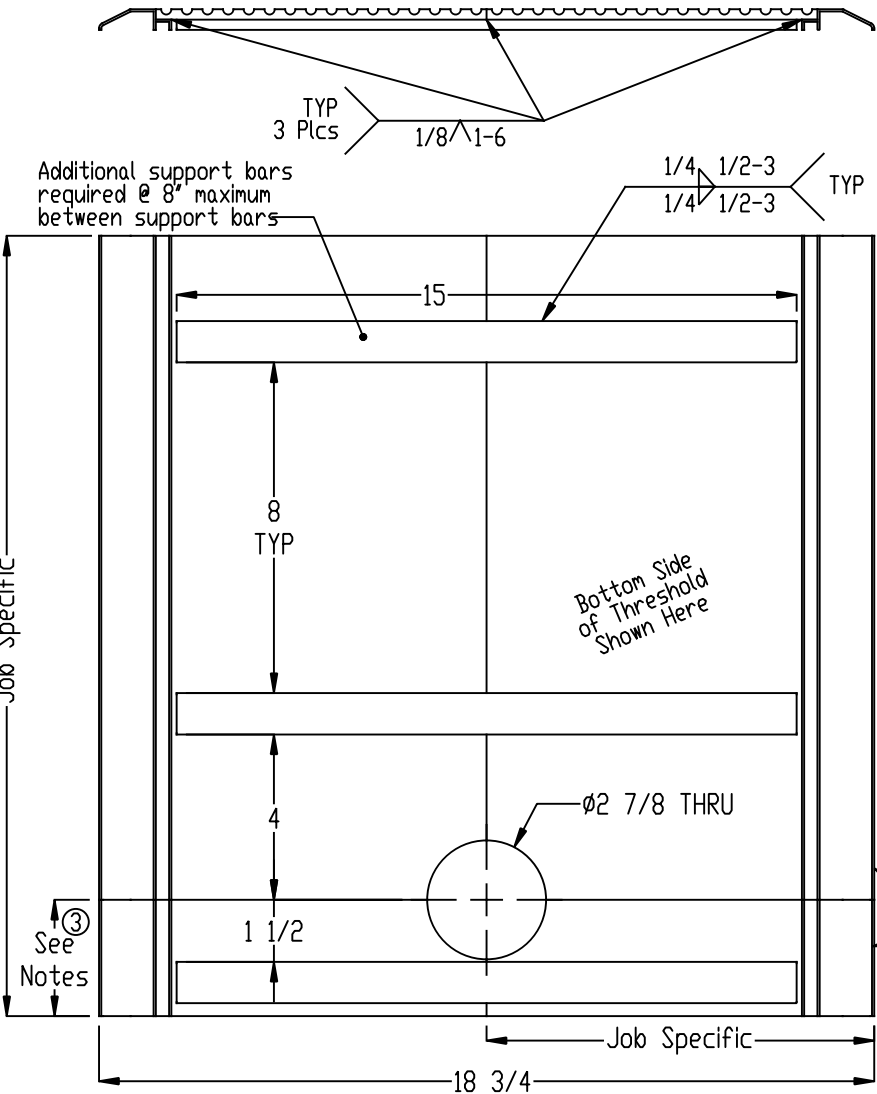

ITEM NO.	PART NUMBER	DESCRIPTION	QTY
1	Pemko 228_	PEMKD 228 (1/4"H x 8"W T'hold) - LH Short	1
2	Pemko 228_	PEMKD 228 (1/4"H x 8"W T'hold) - RH Short	1
3	Pemko 228_	PEMKD 228 (1/4"H x 8"W T'hold) - LH Long	1
4	Pemko 228_	PEMKD 228 (1/4"H x 8"W T'hold) - RH Long	1
5	Pemko 195_	PEMKD 195 (1/2"H x 1-3/8"W Ramp) - Long	2
6	Pemko 195_	PEMKD 195 (1/2"H x 1-3/8"W Ramp) - Short	2
7	Pemko 2957_	PEMKD 2957 (1/4"H x 1"W x 15"L Spacer Bar)	3

- Notes:
- 1) Requires Tormax Stainless Steel Cover Plate PN: US801364
  - 2) PEMKD Components to be furnished by Customer.
  - 3) Minimum 2-13/16' required to conceal the operator box. A pivot offset of less than 2-13/16' will position the operator box under the door jamb and will require trimming the threshold to wrap around the jamb.